

# 3300HP Model Bow Tug - 13753



Ocean Marine Brokerage Service |  
Louisiana  
(985) 448-0409 / Fax: (985) 302-0984

Vessel # 13753 / TG

Contact: Steve Kokinos -  
[steve@oceanmarine.com](mailto:steve@oceanmarine.com)

## REGISTRATION

YEAR BUILT:	1986
BUILDER:	Ingenierie Maritime et Commercialisation, Tonnyay- Charente
FLAG:	Egyptian
CLASSIFICATION:	PR
CONSTRUCTION:	Steel
GROSS / NET TONS:	348 / 82
LOADLINE:	PRS Ice Classed

## LOCATION

LOCATION:	Middle East
-----------	-------------

## DIMENSIONS

LENGTH:	97.11 FT. / 29.6 MT.
BEAM:	28.21 FT. / 8.6 MT.
REG. LENGTH:	100.29 FT. / 30.57 MT.

## CAPACITIES

	Gal.	M Tons	Barrels
FUEL:		150	
POTABLE WATER:		43	

**BALLAST:** 140  
**DECK CAPACITY:** 193

---

## PERFORMANCE

**SPEED:** 12 KTS

---

## MACHINERY

**MAIN ENGINES:** 2 Duvant Crepelle 6 PSNL3  
**HORSEPOWER:** 3300  
**GENERATORS:** Bavdouin  
(2) - 92 KW  
**BOW THRUSTER:** No  
**STERN THRUSTER:** No  
**BOLLARD PULL:** 35

---

## DECK EQUIPMENT

**CRANES:** None  
**STERN ROLLER:** Yes  
**WINCH TYPE:** 100  
**PUSH KNEES:** No  
**SPUD WELLS:** No  
**SPUD WINCH:** No

---

## ELECTRONICS

**AUTO PILOT:** Yes  
**DEPTH FINDER:** Yes  
**PLOTTER:** No  
**EPIRB:** Yes  
**GPS:** Yes  
**RADIO VHF:** Yes  
**RADIO SSB:** Yes  
**RADAR:** Yes

---

## OTHER EQUIPMENT

GMDSS & Navtex, SART, AIS

---

## DESCRIPTION

Used 3300hp Model Bow Tug For Sale. All current certs.Working. Basic nav aids. Forward & aft winches 100 ton holding capacity.35 ton bollard pull.SS & DD 2020.Sellers are known to keep their vessels in excellent condition. Realistic Sellers inviting best offers, as brokers can fully guide

---

Details pertaining to this vessel are obtained from sources believed to be reliable, however we can not guarantee their accuracy. Buyers should instruct surveyors and agents to investigate details for validity. All offers are subject to prior sale, changes in price and / or inventory, and without notice.

***NOTE: See Photos on next page***









MONKEY ISLAND

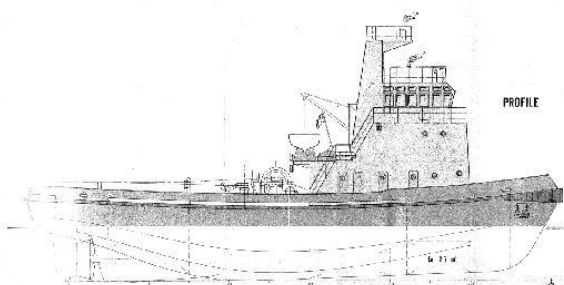

PROFILE



BRIDGE DECK



UPPER DECK

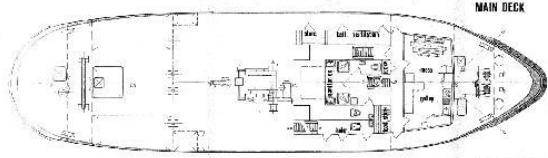

MAIN DECK

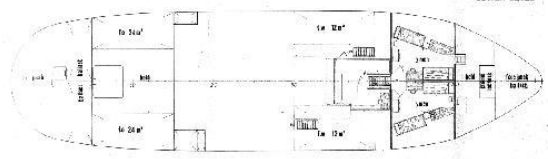

LOWER LEVEL

PARAMETER	UNIT	VALUE
Length (L)	ft	33.00
Length (L)	m	10.06
Beam (B)	ft	12.00
Beam (B)	m	3.66
Depth (D)	ft	10.00
Depth (D)	m	3.05
Displacement	tons	110.0
Speed	kt	11.0
Power	hp	2200
Power	kw	1620

Approved: Submarine Dept. March 10, 1954 (100)

		528 630 PL 1954 1954 1954
<b>ARAB REPUBLIC OF EGYPT</b> GENERAL DEPARTMENT OF DEVELOPING NEW URBAN COMMUNITIES		
<b>DAMIETTA PORT DEVELOPMENT</b>		
PROJECT NO. 1000	CONTRACT NO. 1000	PROJECT AREA 1000
32' Bulbhead Tug		